

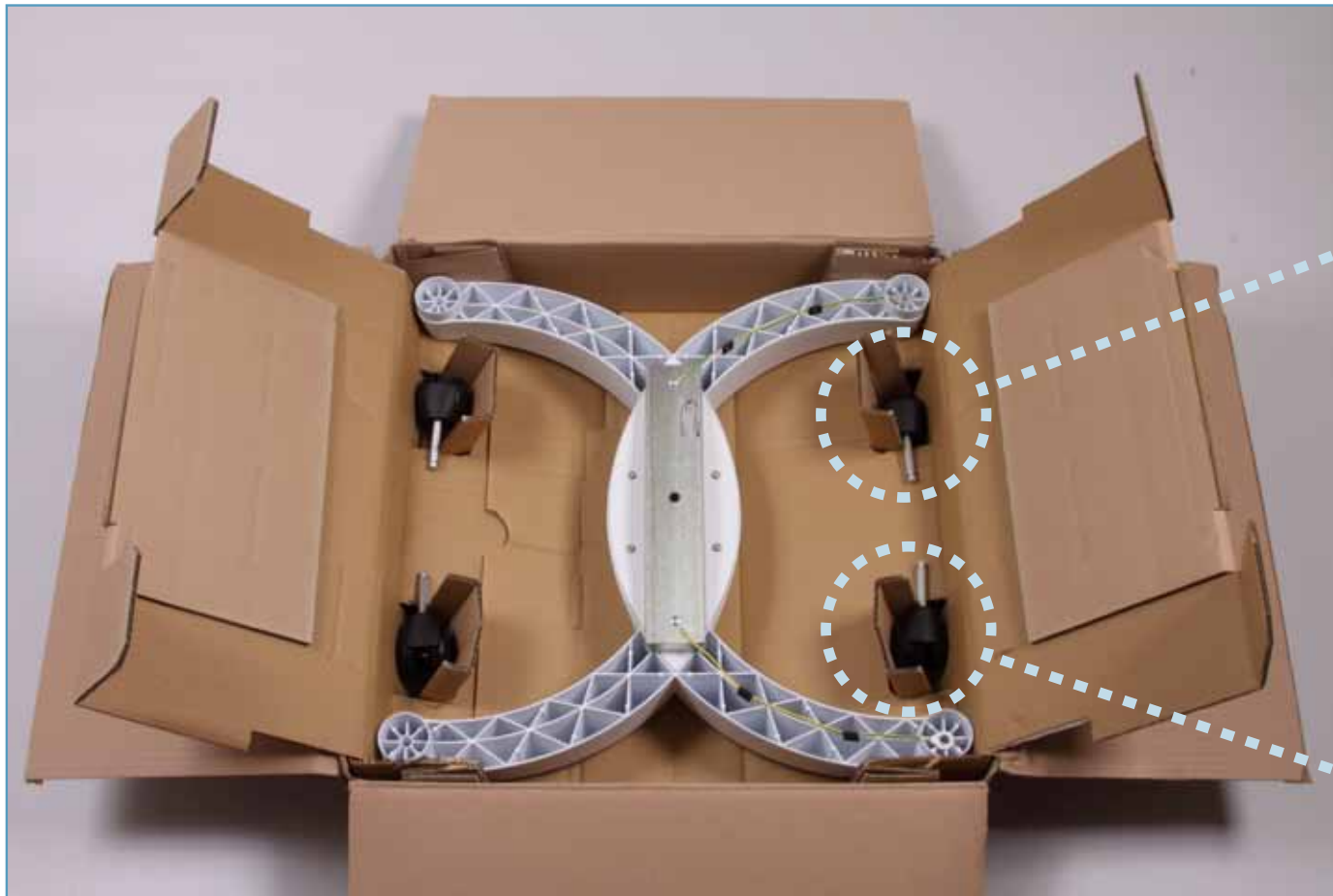

Ships in 3 boxes





(2) wheels without brakes



(2) wheels with brakes



(2) wheels without brakes



(2) wheels with brakes go through the ring cable

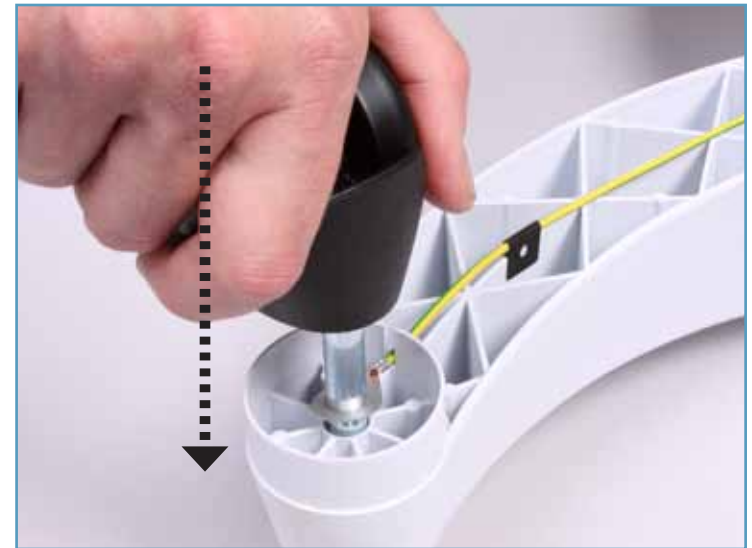

Place wheels with brakes through ring cable and insert completely





Insert two wheels without brakes completely





Parts included with Mobile Stand





Tools not included

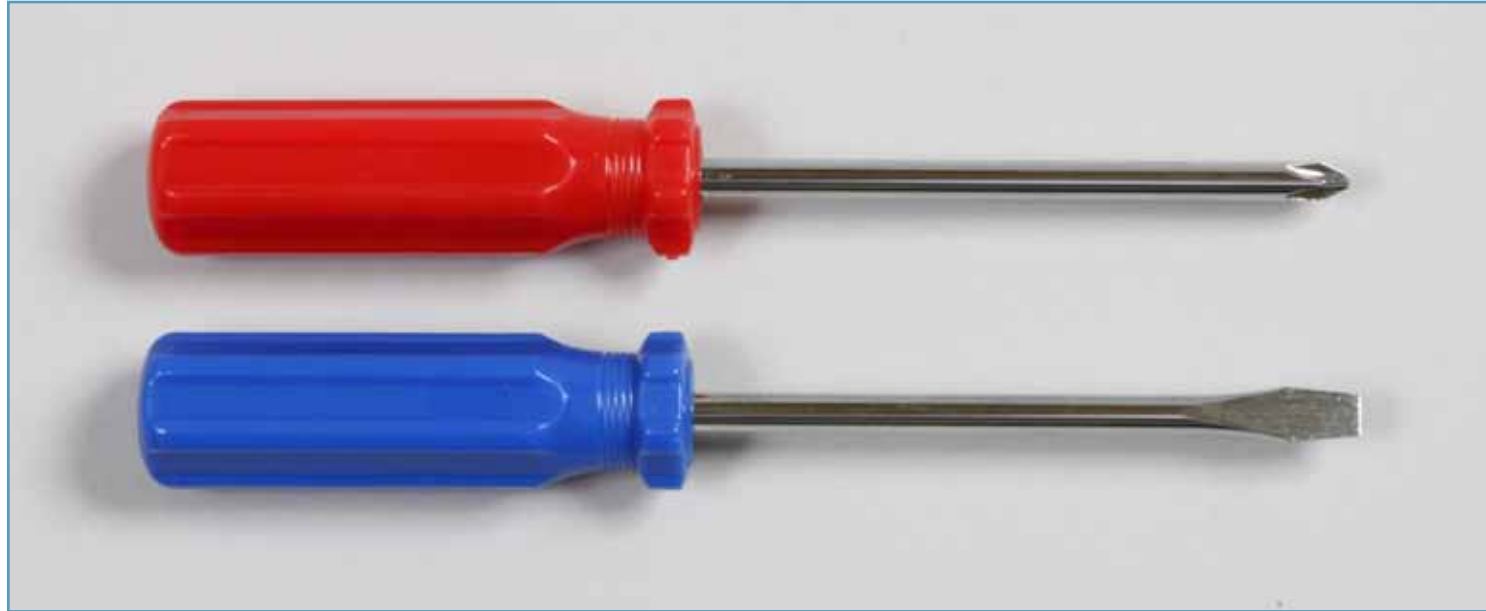

Insert two screws into pole





Insert the tripod tube so that the recess in the tube is seated in the nose of the tripod base and cannot be rotated any more





Assemble the winged screw with the spring washer and tighten









Remove and discard grey protective cover

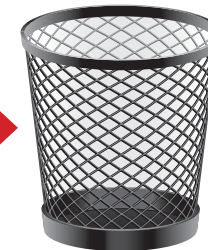

Unscrew the Phillips/plus-slotted screw, pull the cover off, pull cord through the top opening and insert the spring arm



Place the disk over spring arm



Place retaining ring over spring arm and secure into the pin groove

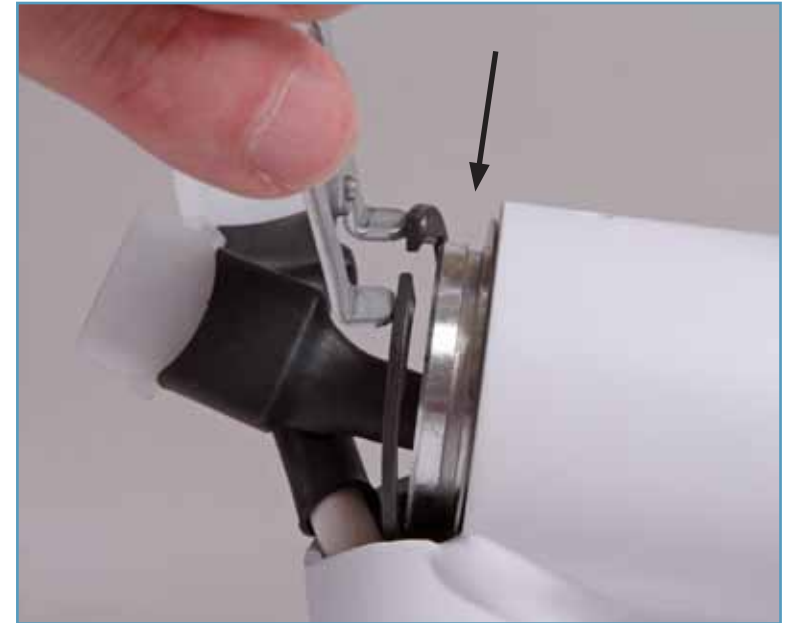



Make the electrical connection, tuck wires back inside, replace cover and tighten Phillips/plus screw





Remove and discard  
grey protective cover





Loosen the slotted/minus screw

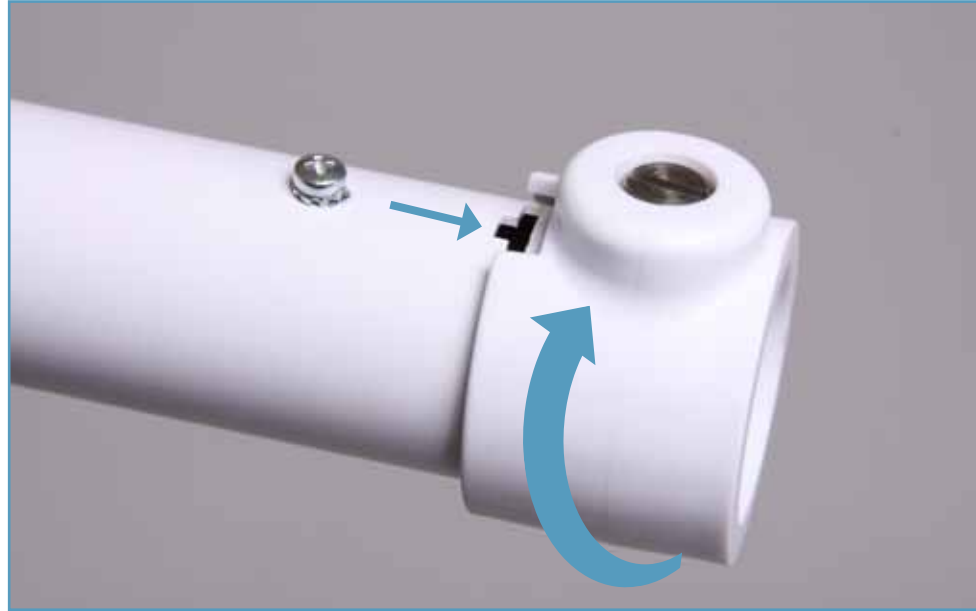

Loosen the Phillips/plus-slotted screw

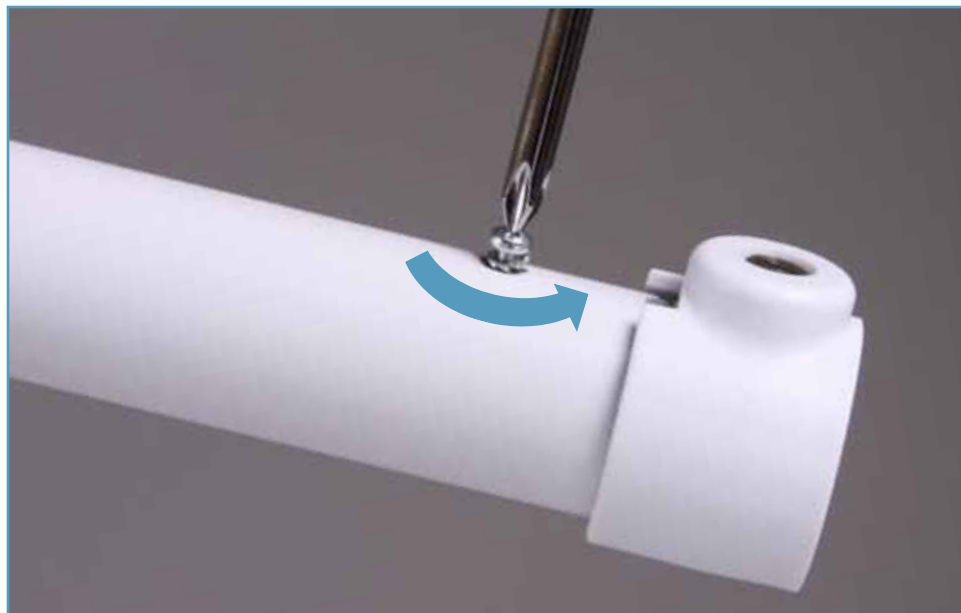



*Luminaire*



Insert luminaire into the spring arm





Place securing segment completely into slot



Tighten the Phillips/plus-slotted screw, turn plastic sleeve 180° and tighten the slotted/minus screw





Plug in electrical connection to the unit and the wall

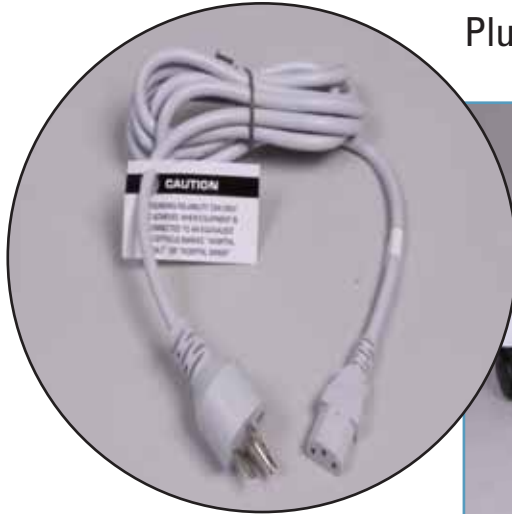



Turn on light

